

# WTH-65/G/1P-255



Requirement class to VDE 0675	B+C
Requirement class to EN 61643-11	Type 1+2
Requirement class to IEC61643-1	Class I+II
Location of use:	Main distribution boards
Protection modes:	N-PE
Protective element:	High Energy GDT
High surge discharge ratings:	$I_{max} = 65kA (8/20)$
Housing:	Compact design

## Technical data

Type	WTH-65/G/1P-255	
In accordance with	IEC 61643-1	
Max. continuous operating voltage (AC/DC)	$U_c$	255V
Nominal discharge current (8/20)	$I_n$	40kA
Max. discharge current (8/20)	$I_{max}$	100kA
Pulsed current (10/350)	$I_{imp}$	10kA
Voltage protection level	$U_p$	< 1.0kV
Follow current	$I_f$	100A RMS
Response time	$t_A$	100ns
Terminal screw torque	Max. 3.5Nm	
Temperature range	- 40°C ... + 80°C	
Terminal cross section	35mm <sup>2</sup> (solid) / 25mm <sup>2</sup> (stranded)	
Din Rail EN60715	35mm top hat rail	
Protection rating	IP 20	
Housing material	thermoplastic; extinguishing degree UL 94 V-0	
Dimensions DIN 43880	1.1TE	
Fault Indication	No	

Ordering code	502 016
---------------	---------

## Installation

### Example:

### WTH-65/B+C/1P+NPE

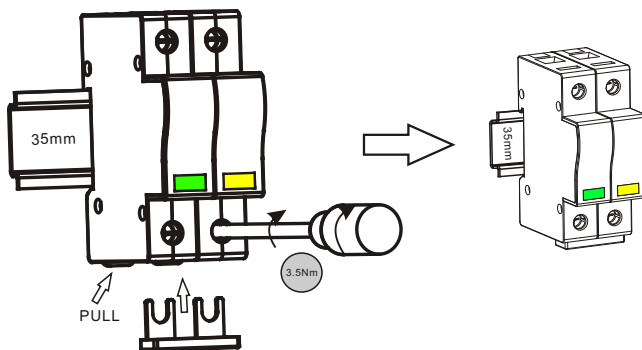

## Single-pole N-PE Lightning & Surge Arrester $I_{max} = 65kA (8/20)$

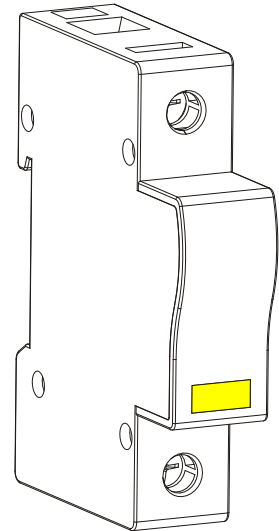

## Connection diagram

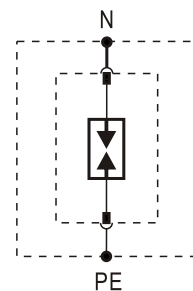

## Dimensions

